



110 Wyndham Road, Salisbury, Wiltshire, SP1 3AQ

An attractive character two bedroom terraced house conveniently situated close to the city centre within a no-through road.

- TWO BEDROOMS
- TWO RECEPTION ROOMS
- KITCHEN WITH COOKER
- GAS CENTRAL HEATING
- CITY CENTRE LOCATION
- REAR GARDEN
- DOUBLE GLAZED
- PERIOD FEATURES

£975 PCM

Ground Floor

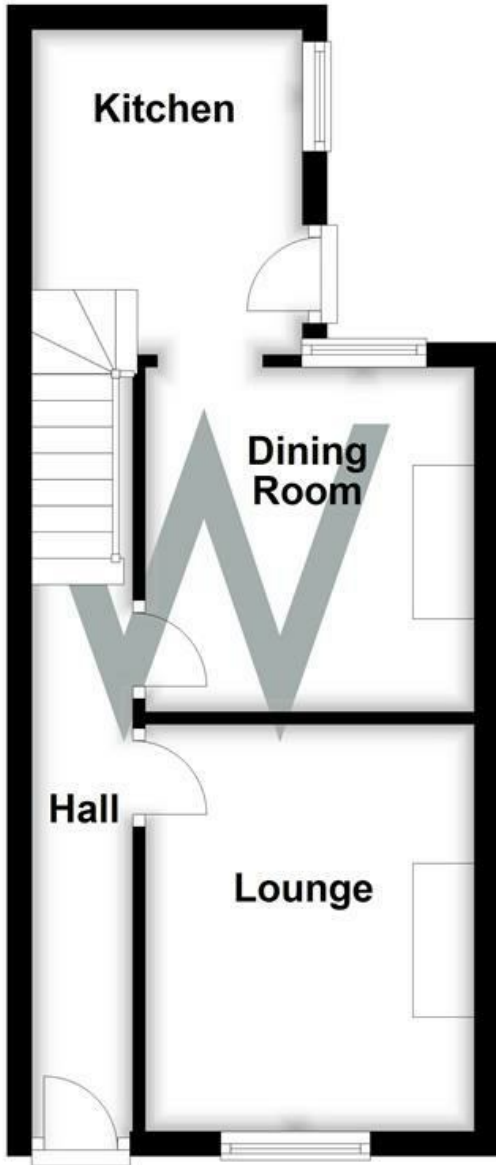

First Floor

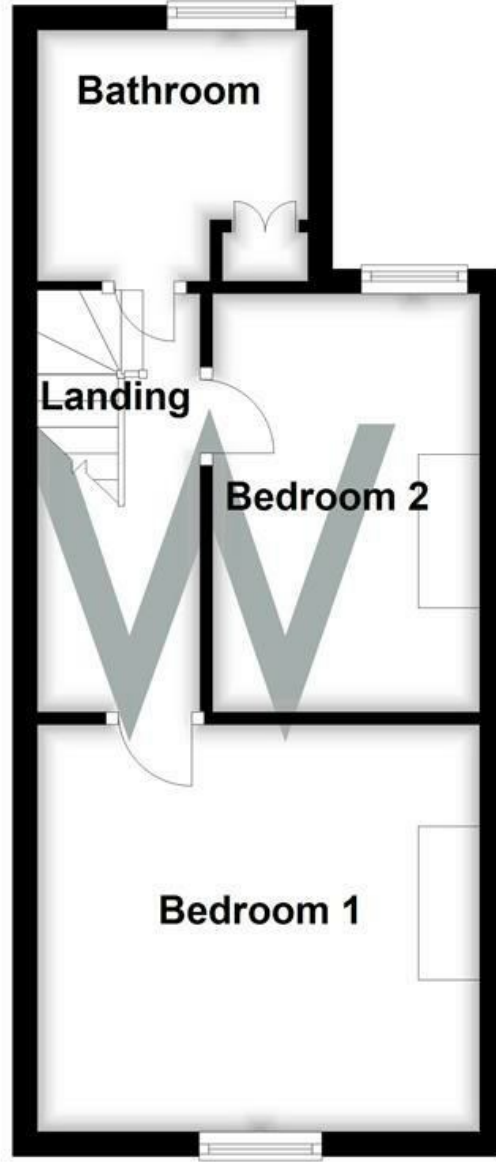

WHITES

Castle Chambers, 47 Castle Street, Salisbury,
Wiltshire, SP1 3SP
Tel: 01722 336422/Option 2
www.hwwhite.co.uk
email: lettings-management@hwwhites.co.uk

| Energy Efficiency Rating | Current | Potential |
|---|-------------------------|-----------|
| Very energy efficient - lower running costs | | |
| (92 plus) A | | |
| (81-91) B | | |
| (69-80) C | | |
| (55-68) D | | |
| (39-54) E | | |
| (21-38) F | | |
| (1-20) G | | |
| Not energy efficient - higher running costs | | |
| | | 87 |
| | 68 | |
| England & Wales | EU Directive 2002/91/EC | |

| Environmental Impact (CO ₂) Rating | Current | Potential |
|---|-------------------------|-----------|
| Very environmentally friendly - lower CO ₂ emissions | | |
| (92 plus) A | | |
| (81-91) B | | |
| (69-80) C | | |
| (55-68) D | | |
| (39-54) E | | |
| (21-38) F | | |
| (1-20) G | | |
| Not environmentally friendly - higher CO ₂ emissions | | |
| | | |
| England & Wales | EU Directive 2002/91/EC | |